



Sandy Park

Conferences & Meetings



WWW.SANDYPARK.CO.UK
01392 427427
events@sandypark.co.uk

Welcome to Sandy Park



Exeter's award-winning Conference, Banqueting and Events Centre and home to Gallagher Premiership Rugby team, the Exeter Chiefs. Sandy Park has the flexibility to host everything from large exhibition events to small meetings, all within easy reach of the vibrant cathedral city of Exeter and the stunning scenery of the Exe Estuary, East Devon and beyond.

Conveniently situated by junction 30 of the M5 and only ten minutes from Exeter International

Airport, we pride ourselves in being one of the South West's most accessible Conference Centres.

With our excellent in-house planning, operational and catering teams, here at Sandy Park we take pride in creating successful events for all of our clients, ensuring the space you have is tailored to your every individual need, enhancing the success and overall enjoyment of your event.

Our Facilities

We have a variety of versatile and dynamic spaces here at Sandy Park, including the impressive Exeter Suite which has hosted a number of notable events, including exhibitions, award shows, charity gala evenings and Exeter Rugby Club's annual End of Season Dinner.

Our top floor suites, the Chiefs, Estuary and Baxter offer striking and unrivalled views of the Sandy Park pitch and stadium and the stunning East Devon countryside. For smaller meetings, our Seminar Suites are ideal and all have moveable walls, enabling various configurations and capacities.

Our passionate and talented catering team specialises in providing top quality cuisine and sourcing the best in local West Country produce. Whether it's a hot buffet for 100 conference delegates, light refreshments for a small meeting or a celebratory three-course gala dinner for 600, we can offer a variety of menus to suit any budget, theme or dietary requirement. All suites are fully air-conditioned.



Our suites are equipped with the latest technology including:

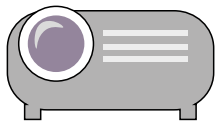

HD Laser projectors

State-of-the-art Panasonic SOLID SHINE laser projectors give unrivalled impact to any event or presentation.

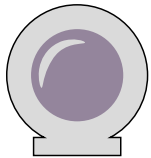

HD Camera

The Exeter Suite has a HD camera which enables real-time streaming both in the Exeter Suite and other suites within the building.



Wifi

Free high speed WiFi throughout the building.



vMix

vMix enables simultaneous streaming on all screens and allows presentations to be more streamlined and displays content such as Twitter feeds.



Plasma screens

Suites are equipped with plasma screens from 42" to 80".



Apple TV

Apple TV has a multitude of uses including screen mirroring from iOS devices to the large screens, streaming music from iOS devices, controlling presentations and uploading content remotely.



PA system & microphones

Each of our main suites has its own integrated PA system.



IR Hearing Loop

Infrared hearing systems are fitted throughout the venue to aid communication with those with hearing impairments.

Exeter Suite

Dimensions: 37.7m x 17.4m (674m²)

Split into two rooms - Dimensions: 18.8m x 17.4m

Ceiling height: 2.85m (max 3.5m)

Features:

4 State of the art Panasonic SOLID SHINE HD Laser projectors 4m x 2.25m screens, 2 Projector screens, 5 Plasma screens, Apple TV, HD Barcam, vMix

Our spacious and light filled Exeter Suite is the largest on site and boasts the latest in audio-visual technology including: 3 high definition data projectors with 8' x 6' screens, 7 large plasma screens and an internal PA system, with a selection of microphones on offer to suit different requirements.

The suite also has a high definition camera, allowing speakers or other activities to be displayed across the screens both in the Exeter Suite and throughout the building. Delegates and organisers can also enjoy wireless streaming of videos and presentations from their devices to the screens via the Apple TV system installed in the suite.

Theatre Style: max 825

Dinner Style: max 600

Cabaret Style: max 487

Fully air-conditioned with two private bars, the Exeter Suite has hosted a number of notable and large scale events including award shows, business exhibitions, charity gala events and Exeter Rugby Club's annual end of season dinner.

One of the most interesting and practical features of this suite is that it can be split into two rooms by a floor to ceiling partition wall. Each of these rooms can comfortably seat up to 390 guests. This convenient feature lends itself very well to meetings or events that require either a separate breakout space, networking zone, exhibition area or catering space.



The County Suite

The County Suite, situated on the first floor, is one of our most versatile suites on site. This suite offers natural day light, air-conditioning and a large private bar.

Conveniently situated adjacent from the Exeter Suite, the County is an ideal room to provide either a reception, break-out space, exhibition zone or catering area for any event taking place in the Exeter Suite.

Dimensions: L-Shape Room - 19.6m (max) / 14.1m (min) x 17.6m (296m²)

Theatre Style: max 240

Dinner Style: max 240

Cabaret Style: max 160

Features: 1 state of the art Panasonic SOLID SHINE HD Laser projector (4m x 2.25m)
4 Plasma screens (1 x 75", 3 x 60", 1 x 42")
Apple TV
vMix



The Estuary Suite

The Estuary Suite is a large, light filled room with a uninterrupted view across the stadium and across to the Exe Estuary. Our second largest suite with its own large and well-stocked bar; the Estuary is perfect setting for any event from a business conference or private dinner.

An extremely practical feature of the Estuary Suite is that it can be divided length-ways by one main moveable wall. This wall allows for a total of six seminar suites which can accommodate a maximum of 15 people in each. These seminar suites have moveable walls themselves – a fantastic room should you require several breakout or syndicate rooms.

Dimensions: 25.0m x 17.5m (315m²)

Theatre Style: max 327

Dinner Style: max 340

Cabaret Style: max 219

Features: 2 state of the art Panasonic SOLID SHINE HD Laser projectors (4m x 2.25m)
4 Plasma screens (1 x 75", 1 x 60", 2 x 42")
Apple TV
vMix



The Board Room

The Sandy Park boardroom is available to hire for meetings for up to 24 delegates.

In addition to the striking boardroom table, this room has the latest in video conferencing technology and an 82" plasma screen. The suite is available to hire on an hourly basis, in addition to half-day and full-day rates.

Dimensions: 10.8m x 4.5m (49m²)

Boardroom style: max 24

Features: 80" Plasma screen
Apple TV
Skype facility
vMix



The Chiefs Suite

The Chiefs Suite is located on the second floor and can comfortably seat a maximum of 220 guests. This suite is similar in size to the County Suite and features its own private bar. The Chiefs Suite has full disabled access, is air-conditioned and naturally day-lit overlooking our pristine pitch and out across to the Exe Estuary. There are seven seminar suites in close proximity to the Chiefs Suite, which are ideal for breakout areas. For larger events, the Chiefs Suite is situated adjacent from the Estuary Suite and is therefore is an excellent room to either provide a reception, registration or breakout area for any event taking place in the Estuary Suite.

Dimensions: 14.7m x 17.5m (273m²)

Theatre Style: max 172

Dinner Style: max 220

Cabaret Style: max 138

Features: 1 State of the art Panasonic SOLID SHINE HD Laser projectors (4m x 2.25m)
3 Plasma screens (1 x 75", 2 x 60")
Apple TV
vMix

The Baxter Suite

The popular Baxter Suite offers unrivalled views of our stadium grounds and across the scenic vista of the Exe Estuary and beyond.

Positioned on the second floor, the Baxter has a maximum capacity of 60 and is ideal for a range of conference or meeting requirements. There is a PA system with microphones installed, plus an 80" plasma screen. Apple TV is also available in this suite, enabling a wireless link from devices to the screen. In addition, the private bar situated within the room lends itself very well to a private dining or VIP drinks event.

Dimensions: 15.0 m x 5.0m (70m²)

Theatre style: max 60

Boardroom style: max 30

Cabaret style: max 30

Features: 80" Plasma screen
Apple TV

The Seminar Suites

We have 18 Seminar Suites at Sandy Park, nine of which have moveable walls and can enable a variety of room configurations and guest capacities; an extremely practical feature and suitable for smaller meetings. All of our Seminar Suites are situated on the second floor with disabled access. They are filled with natural daylight and overlook the rugby stadium grounds and across the East Devon countryside to the Exe Estuary.

Dimensions: min 18m²/max 45m²

Theatre style: max 60

Boardroom style: max 34

Cabaret style: max 30

Features: Large plasma screen in each suite
Apple TV



Floor Plan

FIRST FLOOR

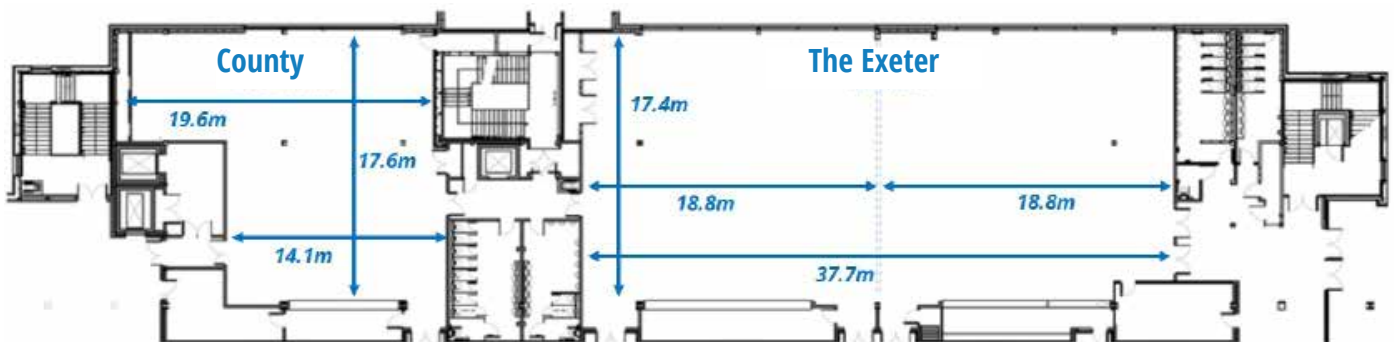

SECOND FLOOR

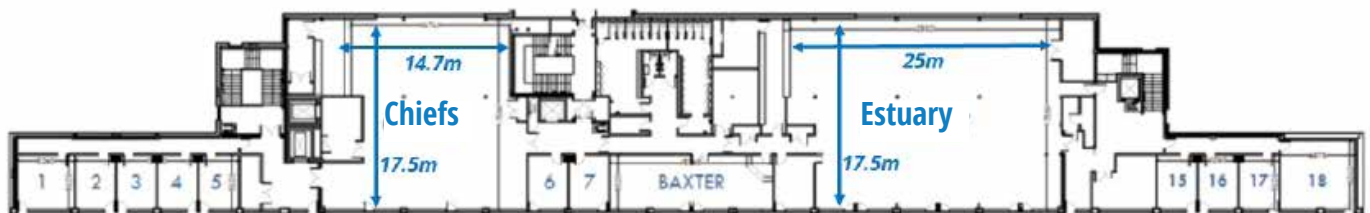

If you would like to enquire about prices please contact us on:

01392 427427
events@sandypark.co.uk

Room capacities and dimensions

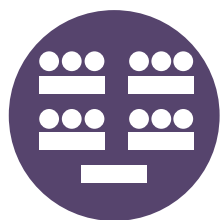

Classroom

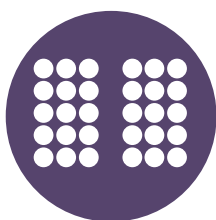

Theatre

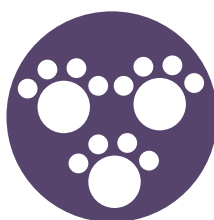

Cabaret

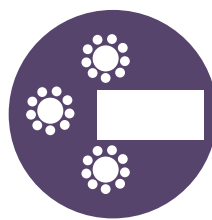

Dinner
Dance

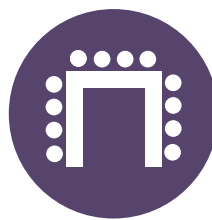

U-Shape

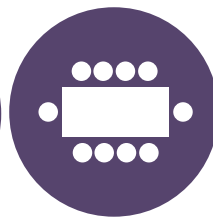

Boardroom

Suite	sq m	Ceiling Height (M)	Theatre	Boardroom	Cabaret (Table of 10)	Classroom (3 per 6ft table)	U-shape with tables & chairs	Dinner w/ Dance Floor (tables of 10)	Exhibition (6ft tables with 2x chairs)
1st Floor									
Exeter 1 & 2	674	2.85 (3.5 max)	825	-	487	348	-	520	100
Exeter 1	342	2.85 (3.5 max)	390	107	248	177	60	177	50
Exeter 2	332	2.85 (3.5 max)	390	107	248	177	60	177	50
County	296	2.85 (3.5 max)	240	80	160	140	50	160	25
2nd Floor									
Seminar Suite(s)*	18+	2.55	15+	12+	10+	6+	8+	-	-
Chiefs	273	2.55 (3.2 max)	172	68	138	104	30	172	30
Baxter	70	2.55	60	30	30	30	25	-	-
Estuary	315	2.55 (3.2 max)	327	110	219	120	50	273	40
Boardroom	49	3.4	-	24	-	-	-	-	-

*For full seminar suite capacities and configurations please speak to your event coordinator.

[To view our virtual tour click here](#)

Day Delegate Package

Complete Day Delegate Package

Minimum numbers will apply

Full day hire of 1x main conference suite
Arrival tea, coffee & biscuits
Mid-morning tea, coffee & biscuits
2-course lunch: choice of either hot fork or finger buffet
Lunch served with tea, coffee & orange juice
Afternoon tea, coffee & mini treats
Data projector, screen & flip chart
1x microphone & PA system
Iced water, stationery & mints
Complimentary WiFi

Budget Day Delegate Rate

Minimum numbers will apply

Full day hire of 1x main conference suite
Arrival tea, coffee & biscuits
Mid-morning tea, coffee & biscuits
Freshly prepared sandwiches & crisps
Lunch served with fresh fruit & orange juice
Afternoon tea, coffee & biscuits
Data projector, screen & flip chart
1x microphone & PA system
Iced water, stationery & mints
Complimentary WiFi

**If you would like to enquire about
prices please contact us on:**

**01392 427427
events@sandypark.co.uk**

Catering Options

Freshly brewed coffee & tea

Freshly brewed coffee & tea with selection of homemade biscuits

Freshly brewed coffee & tea with selection of mini Danish pastries

Selection of fresh fruit slices

Full English Breakfast Menu

Locally sourced back bacon

Locally sourced sausage or vegetarian sausage

Field mushroom

Grilled tomato

Baked beans

Sauté potatoes

Scrambled eggs

Granary toast

Freshly brewed tea & coffee

Light Breakfast Menu

Selection of breads & toast

Mini Danish pastry & croissants

Jams & preserves

Freshly brewed tea & coffee

Bacon, sausage or egg rolls

Jug of fresh orange juice



Hot Fork Buffet

Main Course

A choice of three of the following hot dishes to include accompaniments, side dishes & range of local breads.

- Chickpea & roasted vegetable curry & rice (v)
- Vegetable lasagne (v)
- 3 bean chilli, rice (v)
- West Country beef lasagne & garlic bread
- Vegetable moussaka (v)*
- Seasonal puff pastry pie, roasted vegetables & gravy
- Pork meatballs in spicy tomato sauce & penne pasta
- Honey & mustard chicken in creamy sauce & herbed new potatoes
- Breaded fish cake, mushy peas & crispy potato straws
- Roasted chicken & chorizo paella, smoked paprika & peas (vegetarian option available)
- West Country beef bourguignon & horseradish potato cake
- Minted lamb hotpot & roasted vegetables

**Vegan option also available -*

please make your Event Coordinator aware in advance

Cold Desserts

Please choose 2

- Fresh cream profiteroles, chocolate & salted caramel sauce
- Lemon tart, forest berries & curd
- Classic Crème Brûlée & homemade shortbread biscuits
- Chocolate torte
- Treacle tart, Devon clotted cream & fresh raspberries
- Bakewell fruit tart & vanilla cream
- Chocolate cheesecake & blackberry purée
- Elderflower drizzle cake & glazed blueberries
- Minted poached mixed berries pavlova, vanilla cream candied nuts

If you would like to enquire about prices please contact us on:

01392 427427
events@sandypark.co.uk



Finger Buffet

Finger Buffet One

Sliders with chef's fillings (v)
Marinated chicken fillets
Honey glazed mini cocktail sausages
Roasted red pepper & feta cheese tartlet (v)
Mozzarella, pesto & baby tomato skewers (v)
Mackerel pâté on grilled flat breads
Ham hock terrine bites with piccalilli
Hand baked crisps (v)

Finger Buffet Two

Sandwiches with chef's fillings (v)
Mini meat & vegetarian pasties
Whitebait with chilli mayonnaise
Steak cut chips with sea salt (v)
Stuffed bell peppers with cream cheese (v)
Falafel & red pepper hummus (v)
BBQ belly pork
Tomato, basil & parmesan
cheese bruschetta (v)

Finger Buffet Three

Chorizo sausage roll
Sweet potato fries (v)
Beef burger sliders with gherkins & cheddar
cheese
Crushed avocado on fruit toast (v)
Crispy crab cakes with saffron aioli
Jalapeno mozzarella sticks (v)
Grilled halloumi & courgette skewers (v)
Buffalo chicken wings & sour cream

Finger Buffet Four - Your Style

Choice of 8 items from menus 1-3

Finger Buffet Five

Sliders with chef's fillings (v)
Marinated chicken fillets
Bell pepper & cream cheese (v)
Falafel & red pepper hummus (v)
Ham hock terrine bites & piccalilli
Chorizo sausage roll

Finger Buffet Six

Selection of sandwiches served on fresh bread
with hand baked crisps

Finger Buffet Seven

Warm mini pasty & pie selection to include:
Chicken & mushroom pie
Steak & ale pie
Steak pasty
Cheese & onion pasty (v)

Finger Buffet Mini Desserts

A choice of three from the below selection

Chocolate cheesecake & forest fruit compote
Lemon zest sponge cake, honey mascarpone
cream & ginger crumb
Chocolate cup filled & chocolate orange ganache
Passion fruit cream profiteroles & white
chocolate
Bitter orange curd tart & fresh raspberries
Poached pineapple skewer, spicy syrup &
coconut cream
Selection of mini macarons
Chocolate & raspberry torte
Bakewell tart
Coconut & raspberry tart
Seasonal fruit skewers

Fresh Fruit

Fresh Fruit platter slices
To include 4 fruits



GETTING TO SANDY PARK

Sandy Park is conveniently located just off Junction 30 of the M5, meaning travel to us from Devon and beyond is extremely straightforward.

We are also 10 minutes away from Exeter Airport, on a main cycle route, served by both Digby and Sowton and Newcourt railway stations and within easy reach of Exeter City Centre.

VISITING BY CAR

There is an on-site car park at Sandy Park with over 500 spaces. We work with Premier Park who operate an Automatic Plate Recognition (ANPR) system whereby all vehicle registrations will be captured on arrival and departure by camera.

All visitors will need to enter their vehicle registration number at one of the machines in the car park. There is no need to display the receipt in the vehicle once paid. Visitors can top up at a machine or by RingGo if overstayed.

Charges are as follows:

Up to 1 hour: £1.00

Up to 5 hours: £2.50

Up to 14 hours: £4.50

Up to 24 hours: £6.00

Find out more at www.sandypark.co.uk

VISITING BY BICYCLE

Sandy Park is on a main cycle route and can be easily reached from all directions. There are cycle racks on site where you can leave your bike.

There is no on-site parking on match days. Find out more about getting to Sandy Park on Exeter Chiefs match days on the website.

VISITING BY BUS

South West Falcon (Plymouth to Bristol)

This is a 24/7 coach service providing connections between Plymouth, Exeter, Taunton, Bristol Airport and Bristol City Centre. Tickets can be pre-booked via megabus.com or bought direct from the driver on the day of travel.

Visit www.swfalcon.com to find out more.

Service 9/9A (Exeter to Sidmouth)

Buses from Exeter city centre run up to every half hour, 7 days a week.

VISITING BY RAIL

Sandy Park has two rail stations in close proximity, both on the Avocet Line between Exeter and Exmouth. Travellers to and from Exeter are advised to alight at Digby & Sowton, whereas those travelling to or from Exmouth should use Newcourt. Both stations are clearly signposted from Sandy Park and are approximately a 15 minute walk away.

Alternatively, Exeter's two main rail stations, Exeter St David's and Exeter Central are located approximately 5 miles from Sandy Park. Taxis are available at both stations with an approximate journey time of 15 minutes.



WWW.SANDYPARK.CO.UK

01392 427427

events@sandypark.co.uk